



# Creek Haven Flats

@ Sholinganallur



ARCHITECT  
M. VIJAYA KKR  
A-2 VASANTH APARTMEN  
NO. 11, MELONY STREET  
T. NAGAR, CHENNAI-6000  
Ph.no : 24360277.

Used Building For  
in at Kumaran Colony

## Builder Information

---

**Vedic Partners**  
No-20, First Avenue,  
Sastri Nagar,  
Adyar, chennai-600020  
[Vedicpartners@yahoo.com](mailto:Vedicpartners@yahoo.com)  
9840111511 /9840246995

## Site Address

---

**Plot No:183, 12<sup>th</sup> Cross Street,  
New Kumuran Nagar,  
Sholinganallur,  
Chennai - 600119**



## Project Advantages

Home to number of major IT companies (SEZ Tech park) - Wipro, Infosys, TCS, PayPal, eBay, Mahindra Satyam, CTS

MMDA Approved Layout – New Kumuaran Nagar

Sholinganallur  
The Heart of OMR

Close to Global Hospital, CBSE & International schools, Engineering Colleges

Proximity to beaches and other entertainment venues at ECR



# Ground Floor

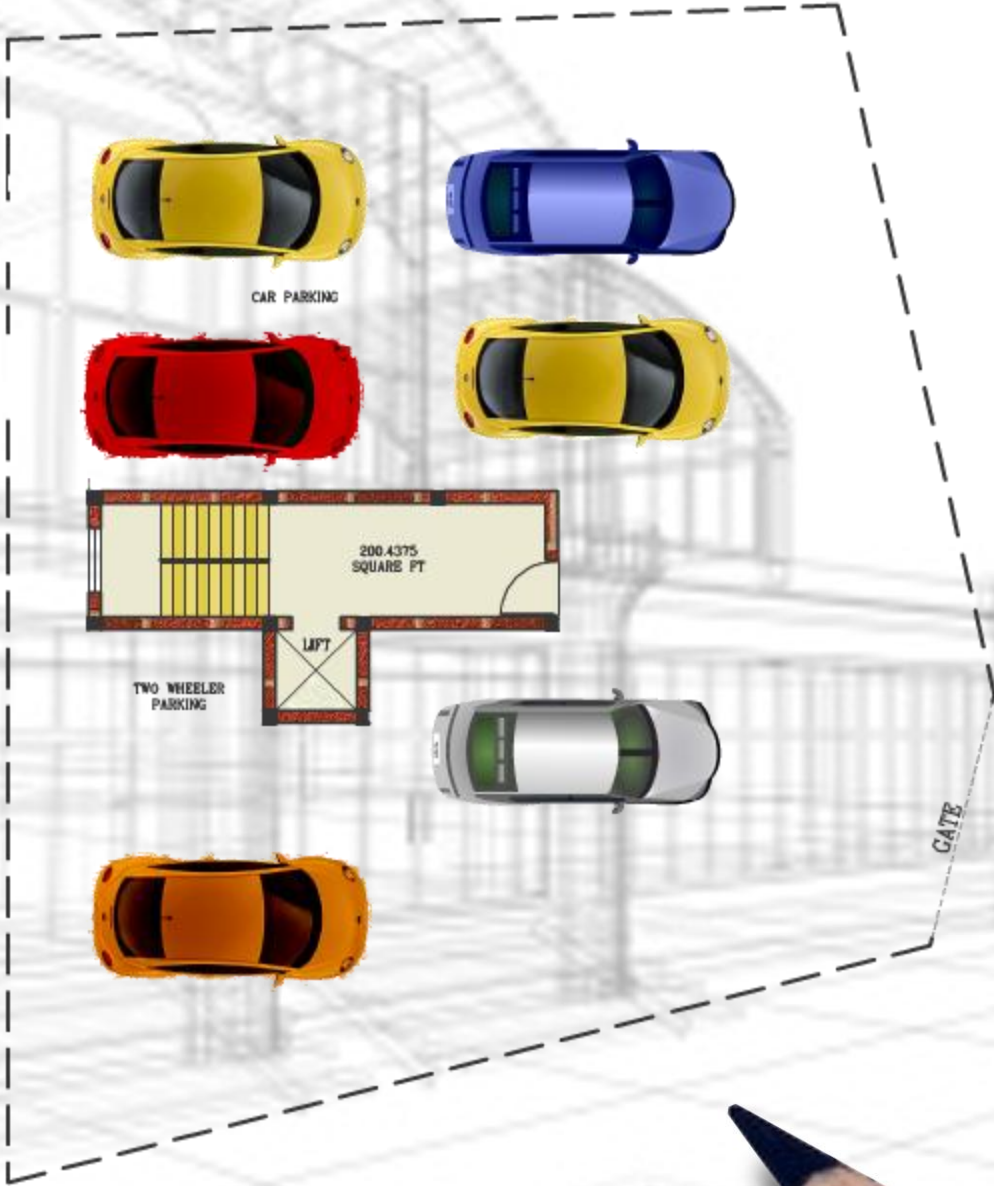



# First Floor



**Flat No**

**Flat Type**

**Flat Area**

F1

2 BHK

963 Sq ft

F2

3 BHK

1311 Sq ft

F3

2 BHK

963 Sq ft





# Second Floor



| Flat No | Flat Type | Flat Area  |
|---------|-----------|------------|
| S1      | 2 BHK     | 963 Sq ft  |
| S2      | 3 BHK     | 1311 Sq ft |
| S3      | 2 BHK     | 963 Sq ft  |





This site is reserved.

## 2 BHK 3D View

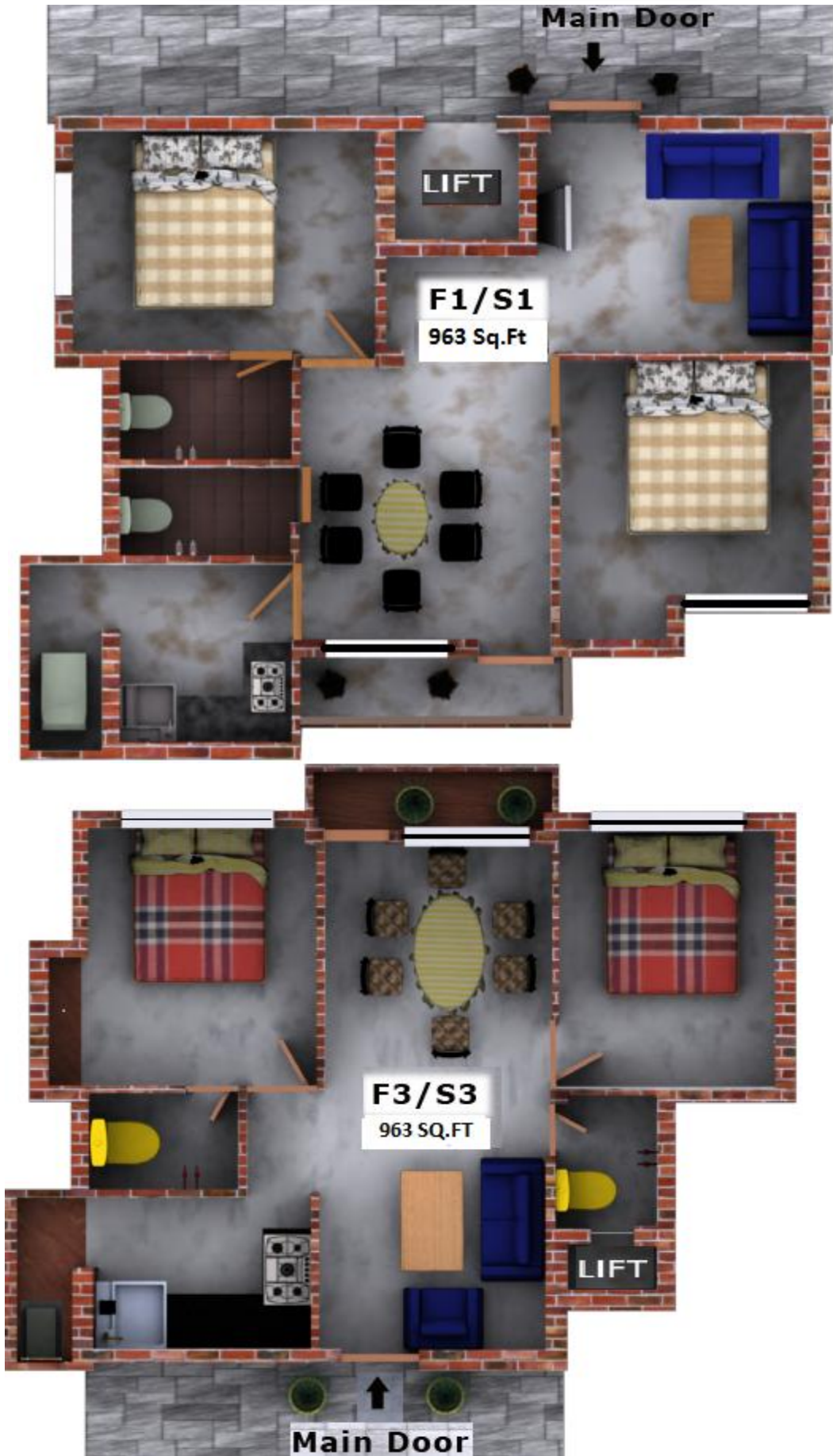



## 3 BHK 3D View





# Specifications

## Structure

- RCC framed structure with Pile foundation to with stand Seismic Zone III loads

## Wall Finishes

- Internal walls will be finished with smooth finished cement plaster, wall Care putty coats and emulsion paint
- External walls will be finished with smooth finished cement plaster, white cement coat and weather proof exterior emulsion paint .
- Toilet / Utility walls will be finished with designer glazed ceramic tiles till 7' ft height as per architect concept.

## Floor Finishes

- Living, Dining, Kitchen and Bedroom areas will be finished with 2'ft x 2'ft designer vitrified tiles with 4" high skirting.
- Toilet and Utility areas will be finishes with acid proof anti skid ceramic tiles

## Kitchen

- Counter top platform will be provided with 20mm thick galaxy black granite slab 2'0" width at a height of 2'6" from the finished floor level along with stainless steel single bowl sink and CP long body tap

## Doors, Windows and Ventilators

- Main Door will be provided with seasoned and polished teak wood frames along with teak wood doors. Superior quality stainless steel fittings with Godrej mortise double lock will be provided.
- Bedroom and Toilet doors will be provided with seasoned country wood frames with wood molded flush doors and water proof doors with required fittings.
- All Windows will be provided with branded UPVC Open able or Sliding windows with clear glass based on the room type

## Electrical

- Concealed conduits with modular switches, split A/C power points, TV and Telephone points will be provided in living, all bedrooms and dining.
- 3 Phase power supply will be provided for each flat with individual distribution box having MCB's and manual phase change over rotary switches

## Plumbing and Sanitary

- Internal concealed plumbing lines and external plumbing lines will be provided with ISI branded CPVC pipe. Waste water and sewage lines will be provided with PVC pipes.
- All CP fittings - 2 in 1 wall mixer, Shower, Health facets , wash basin, European water closet will be provided with Jaguar / Parry ware or equivalent branded company.





## Amenities

- Four passenger lift will be provided
- Individual Power backup will be provided
- Vaastu Compliant Flats
- Bore well with 24 hours water supply will be provided
- Rain water harvesting will be done

## Preferred Bankers





# Location Map

